

Spectra ST¹

Universal Composite Restorative

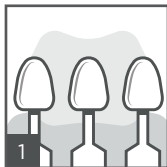

Shade selection

Use the VITA^{®2} Shade Guide and i-shade label or the Spectra ST shade fingers.

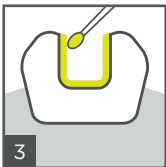
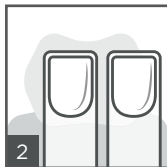

Conditioning and/or bonding

Apply acid conditioner followed by adhesive or self-etching adhesive. Consult directions for use.

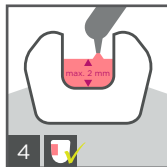

Placement of restorative

Place increments of a maximum of 2 mm.

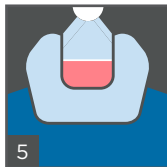

Light-curing

Light-cure each increment according to provided curing chart.

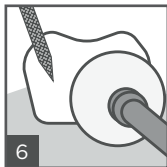

Finishing and polishing

Shape and contour, finish and polish (e.g. with Enhance[®] Finishing System and Enhance[®] PoGo[®] Polishing System).

¹ Depending on market location, Spectra ST is available as either TPH Spectra[®] ST, Ceram.x Spectra[™] ST, or Neo Spectra[™] ST.

² VITA[®] is not a registered trademark of Dentsply Sirona, Inc.



Caution, consult directions for use

Spectra ST¹

Universal Composite Restorative





Shades available

Spectra ST

Universal CLOUD shades:
A1, A2, A3, A3.5, A4

Additional shade:
BW (Bleach White)

Curing Chart

Shade	 mW/cm ²	 sec	 mm
A1- A4	≥ 550	20	2
BW	≥ 800	10	

i-shade label

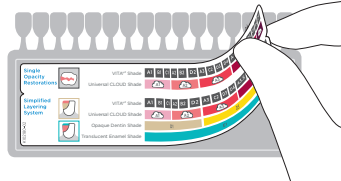

Stick i-shade label to VITA^{®2} Shade Guide

Shade Guide

	VITA ^{®2} Shade	A1	B1	C1	A2	B2	D2	A3	C2	D3	D4	A3.5	B3	B4	C3	A4	C4	+ BW (Bleach White)
	Universal CLOUD Shade	A1			A2			A3				A3.5			A4			